

# 雅2004以降 伸縮部材追加一覽

008 笠石

pa211001A

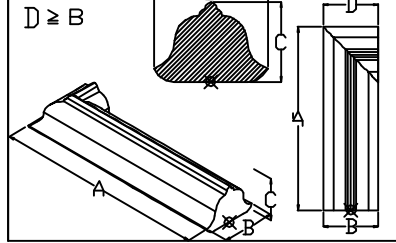

笠石<側面>

pa211002A

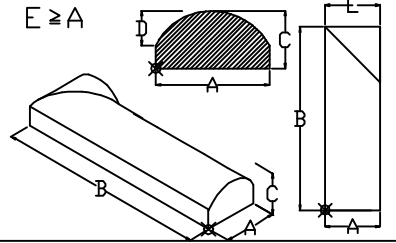

笠石<天端カマコ型>

pa211003A

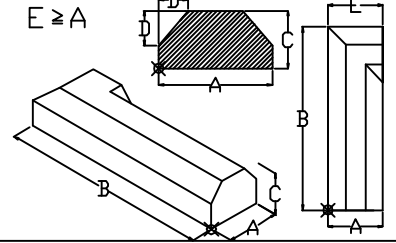

笠石<高麗角面>

pa211005A

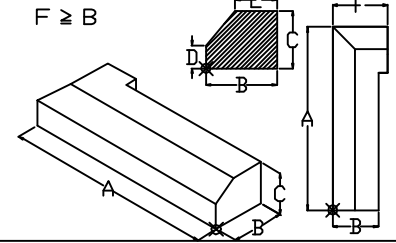

笠石<片側面>

pa211101A

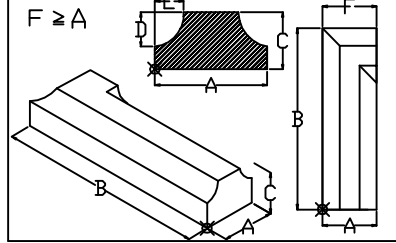

笠石<側面逆R面>

pa211102A

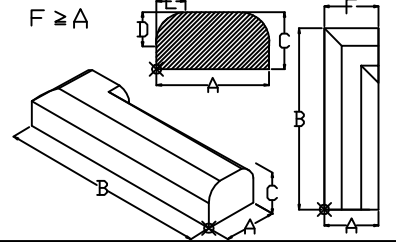

笠石<側面R面>

pa211103A

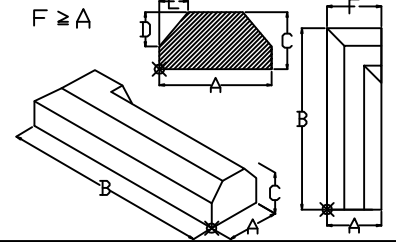

笠石<側面角面>

pa211201A

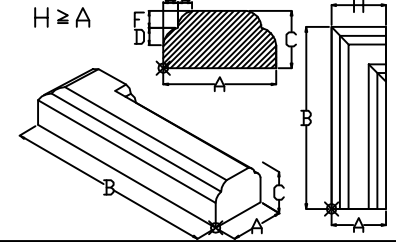

笠石<側面2段R面>

pa211202A

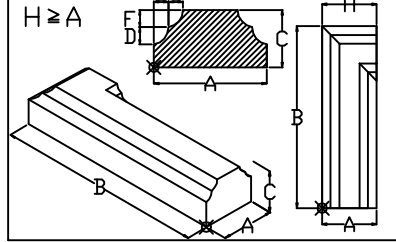

笠石<側面之段R面>

pa211203A

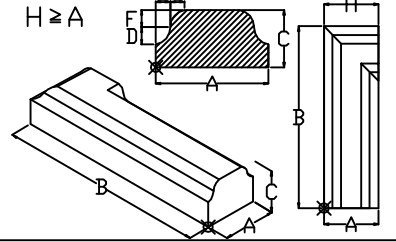

笠石<側面角面>

133 下台・中台・上台

pa207018A

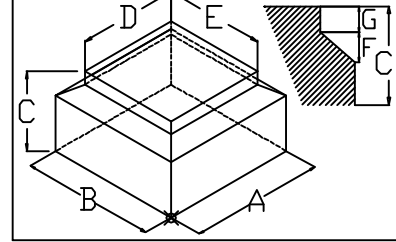

台<天端水差ノ香箱付>

pa207019A

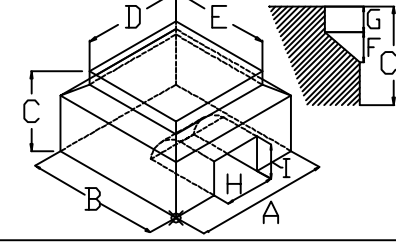

台<天端水差ノ香箱ノ缺付>

132 洋墓

pa216729

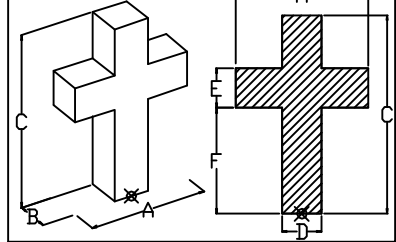

005 階段 / 00 階段

PA204049B

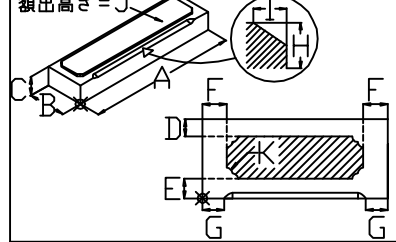

階段<之段R面取厚出ノ面取付>

PA204049C

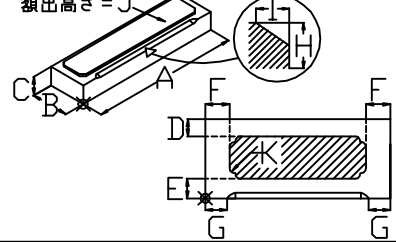

階段<之段R面取厚出ノ面取付>