

雅2000 伸縮部材追加一覽

親柱／門柱

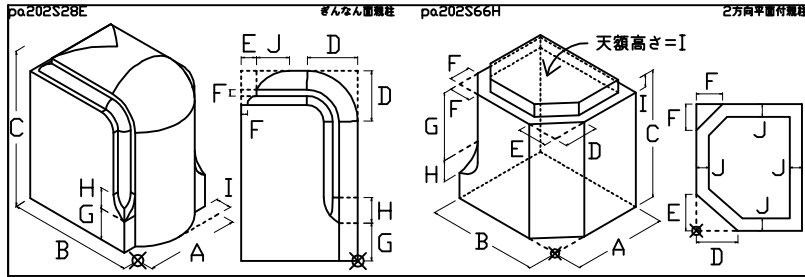

拝石

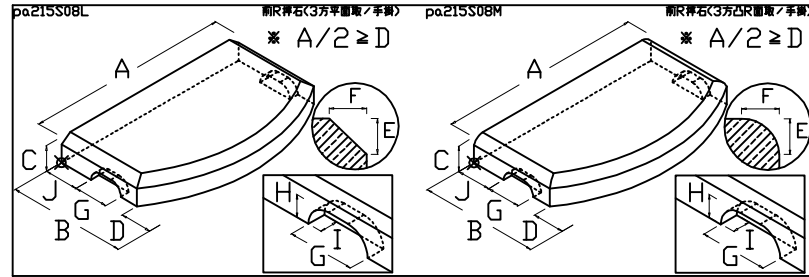

階段

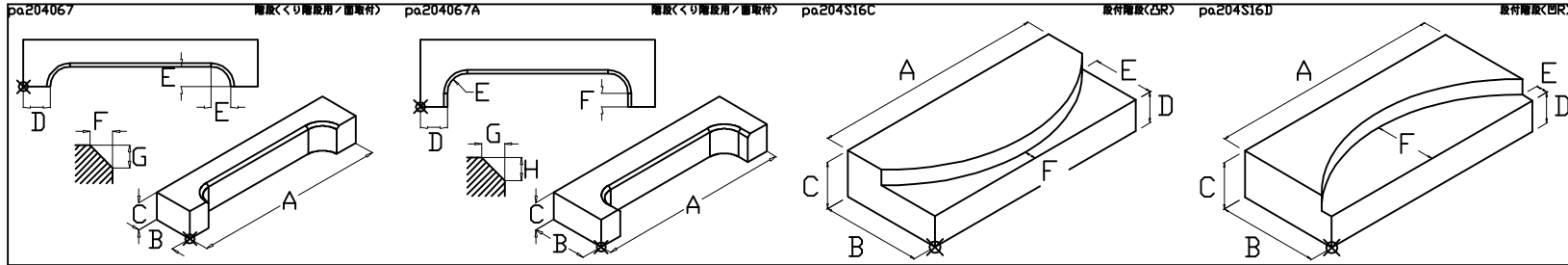

pa204S21C

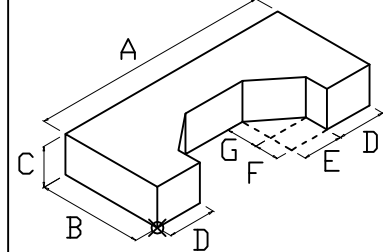

pa204S23G

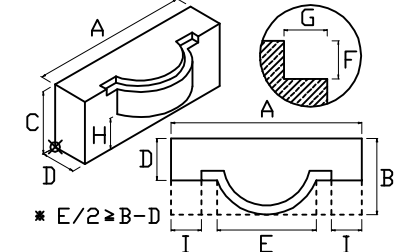

pa204S24H

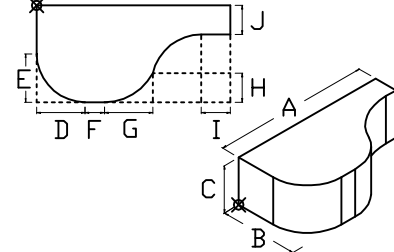

洋基

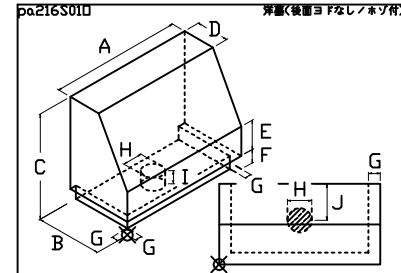

舞台

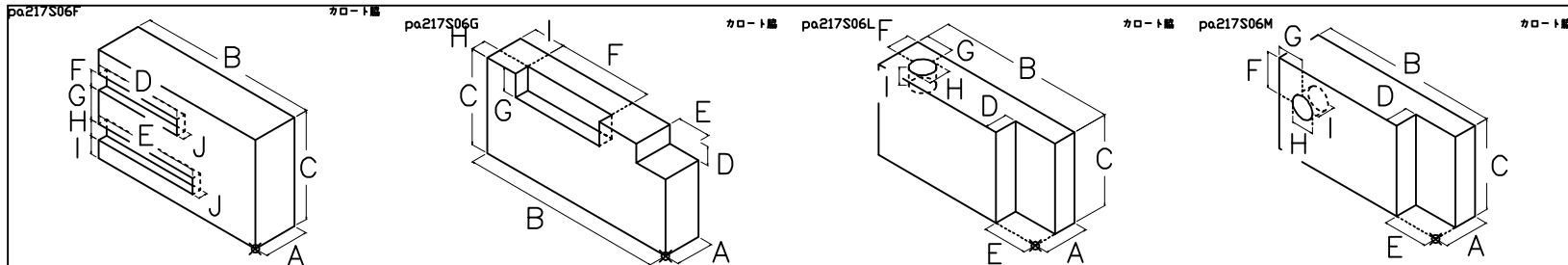

下台／中台／上台

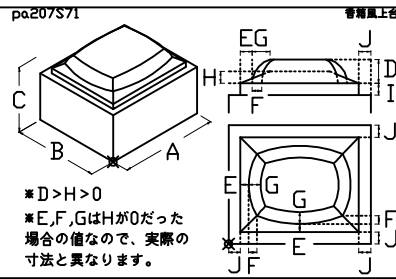
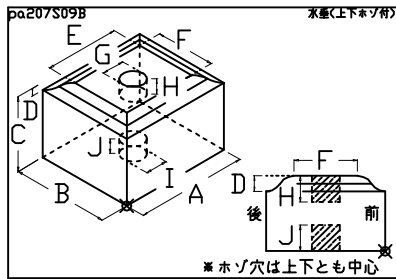
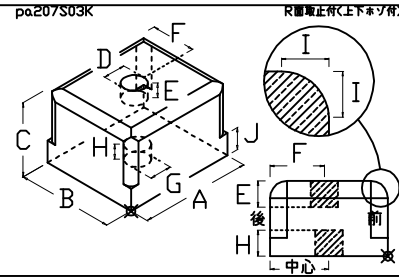
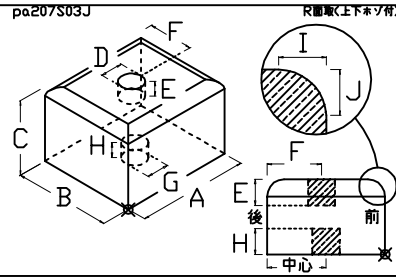
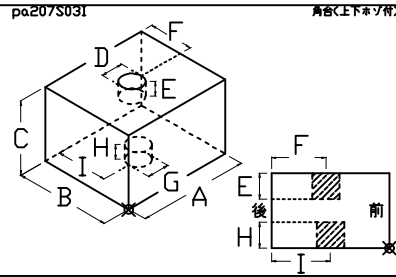
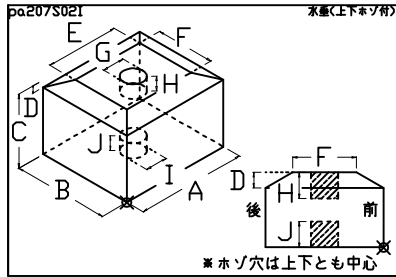

外柵

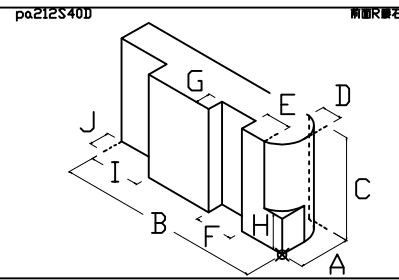
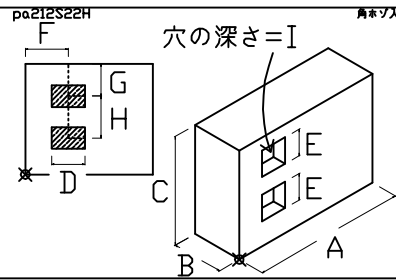
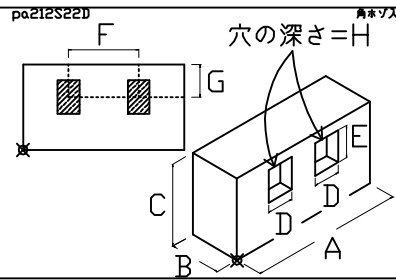
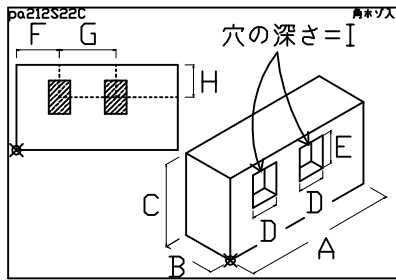
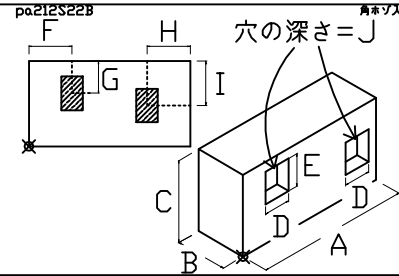
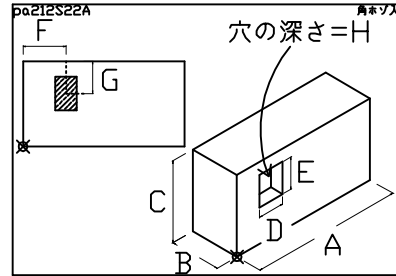

羽目／玉垣(1)

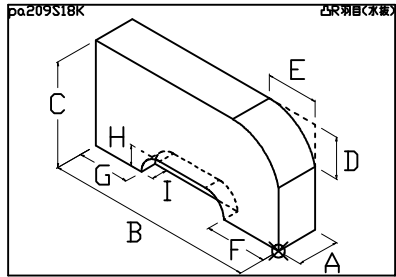

抜き型

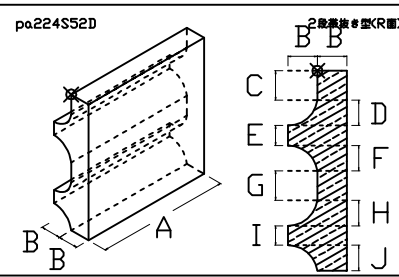
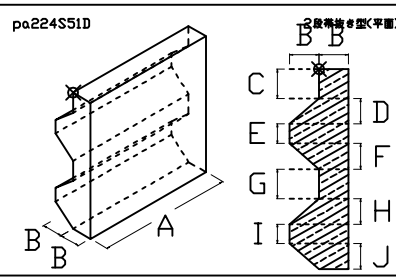
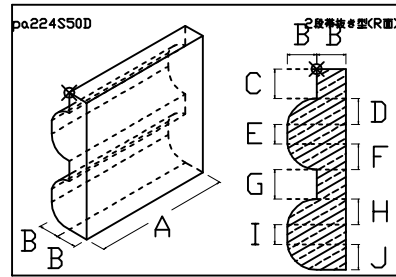

花立／香炉

pa214116

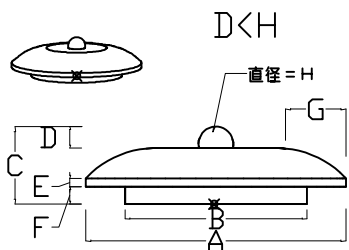

pa214S13H

縦着立開閉R<3方ヨコ>

pa214S20B

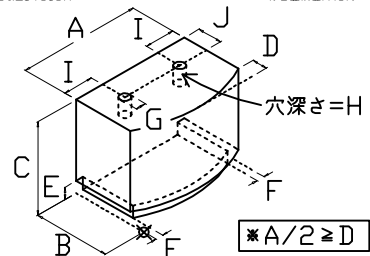

高さ縦<4面ヨコ>

pa214S20C

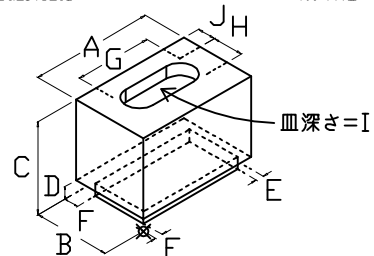

高さ縦<4面ヨコ>R皿深

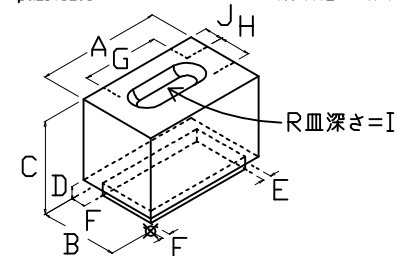

pa214S95H

ステンレス縦着立開閉<角型縦着立開閉>

